

MAX 7500-PRO

LOOKING FOR CRYSTAL CLEAR PICTURE & SOUND?



MAX[®] 7500-PRO

HOME THEATER POWER MANAGEMENT

TOP BENEFITS

- 1** The MAX[®] 7500 PRO has been specifically engineered to improve the performance and life expectancy of home theater equipment. The combination of sophisticated power conditioning and the world's finest power protection has resulted in an audio/video power center that meets the power quality needs for the entire entertainment system.
- 2** At the heart of the MAX[®] 7500-PRO is an advanced power filtration system featuring a 720VA isolation transformer, that provides power for digital source components and displays.
- 3** In addition, any noise generated by digital source components is isolated and prevented from reaching key audio or video components. The MAX[®] 7500-PRO's ground isolation feature mechanically interrupts ground loops, making the MAX 7500-PRO especially useful for applications with unstable power or ground issues. IP addressable, the MAX 7500-PRO is also ideal for multi-zone audio/video whole-home automation and wherever remote diagnostics are needed. RS-232 communication comes standard with the unit and a TCP/IP card is optional. End users can configure each outlet bank individually to customize for their home theater system.

FEATURES

- Remote diagnostics (IP-ready with optional Ethernet card)
- Ground Isolation – Advanced Video Filtration
- Voltage regulation and Balanced Power
- Automatic Voltage Monitoring (AVM)
- Universal Coax Connectors for Satellite (SAT) and Cable Access Television (CATV) protection
- Telephone (TEL) and Local Area Network (LAN) protection
- Auto dimming meters
- DC trigger Input & Output
- 11 Outlets: 2 Always On, 6 Switched, 2 High Current, 1 Convenience (front)
- Rack Mounting Brackets Included
- Optional Silver Bezel
- Convenience lamp



MAX® 7500-PRO BACK PANEL FEATURES

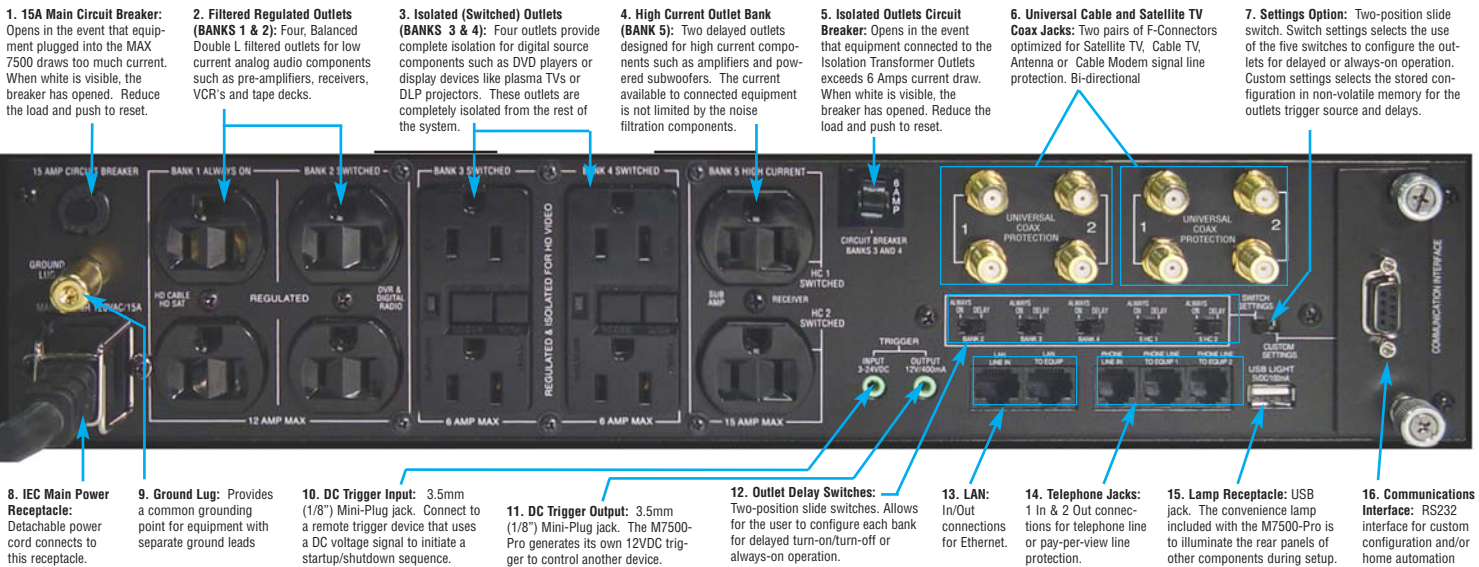

MAX® 7500-PRO SPECIFICATIONS

General	
Dimensions.....	17 in. W x 12.75 in. D x 3.5 in H, (4.1 in. Including feet)
Weight.....	36 lbs.
AC Power	
Line Voltage.....	120V, 60Hz
Regulation Range.....	100V-135V
Regulated Output.....	120V ± 2V
Total Current Capacity.....	15 A
Suppression Rating.....	330V
Protection Modes.....	L-N, L-G, N-G
Initial Clamping Level.....	200V
Energy Dissipation.....	2670 Joules
Peak Impulse Current.....	162,000 Amps
Catastrophic Surge Circuit.....	Yes
Thermal Fusing.....	Yes
Over-voltage shutoff.....	142 VAC ± 5 VAC
Under-voltage shutoff.....	90 VAC ± 2 VAC
EMI/RFI Noise Filtration	
Banks 1 - 4.....	100 db, 100 KHz – 2 MHz
Bank 5, High Current Outlets.....	60 db, 100 KHz – 2 MHz
USB Light	
Voltage.....	.5VDC
Current.....	100mA
DC Trigger Input	
Jacks.....	3.5mm mono mini-plug
Voltage and Polarity.....	3 - 24V DC, bidirectional
Current Requirement.....	4.6 mA @3V, 58 mA @24V
Design and specifications subject to change without notice due to product improvement.	
DC Trigger Output	
Voltage.....	<12V
Current.....	<400 mA
Short-circuit protection.....	Yes
Delay on output.....	10 seconds
LAN Circuit	
Clamping Level.....	8V ± 2V
Jacks.....	RJ-45
Wires Protected:.....	4-Wires, Pins 1, 2, 3 & 6
Telephone Circuit	
Fuseless/Auto-resetting.....	Yes
Clamping Level.....	260V
Capacitance.....	30pf (approx.)
Suppression Modes.....	Metallic & Longitudinal
Connections.....	RJ-11
Lines Protected.....	2-Wire, Pins 4 & 5
Universal Cable and Satellite TV Circuit	
HD Ready 1080 i/p.....	Yes
Shielded.....	Yes
Clamping Level.....	75V
Frequency Range.....	.0MHz - 2.2GHz
Insertion Loss.....	<0.5 dB
Connections.....	Female F, Gold Plated
Bidirectional.....	Yes

UPC's, QUANTITIES, WEIGHTS & MEASUREMENTS FOR ORDERING & SHIPPING

MODEL M7500-PRO		UNIT CARTON			MASTER CARTON				
Dimensions	Weight	Dimensions	Weight	UPC	Qty	Dimensions	Weight	UPC	
17" x 12.75" x 3.5" 4.1" H with feet	36 lbs	23.75" x 18.5" x 10"	39.5 Lbs	0 50616 00806 8	1	Same as Unit Carton	39.5 Lbs	5 00 50616 00806 3	

OPTIONAL SILVER BEZEL

SILVER BEZEL		PRODUCT		UNIT CARTON			MASTER CARTON			
Model #	Dimensions	Weight	Dimensions	Weight	UPC	Qty	Dimensions	Weight	UPC	
BEZ7500-PRO-S	17" W x 0.625" D x 3.5" H	14 Oz	18" x 4" x 1"	17.5 Oz	0 50616 00789 4	N/A	N/A	N/A	N/A	



1690 Corporate Circle, Petaluma, CA 94954 • 800-472-5555 or 707-283-5900 • Fax - 707-283-5901 • www.panamax.com

© 2007 Panamax, Inc. Panamax, MAX and the Panamax logo are registered US trademarks of Panamax.